

PIANO PER L'EDILIZIA ECONOMICA E POPOLARE

Adozione Delibera Consiglio Comunale n. 56 del 12 FEB. 1985

ZONA CIPOLLETO (2)

TAV. 3
PIANO
1:500

UFFICIO URBANISTICA



Minelli Pico

GUBBIO 22 GEN. 1985

LEGENDA VIABILITA'

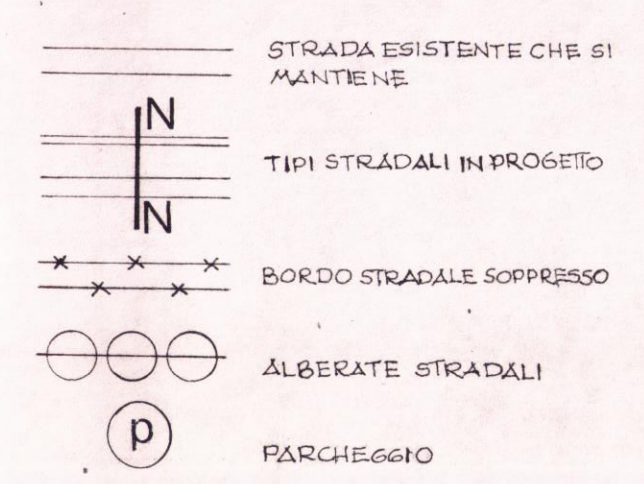

TIPOLOGIA STRADALE 1:100

ZONE RESIDENZIALI

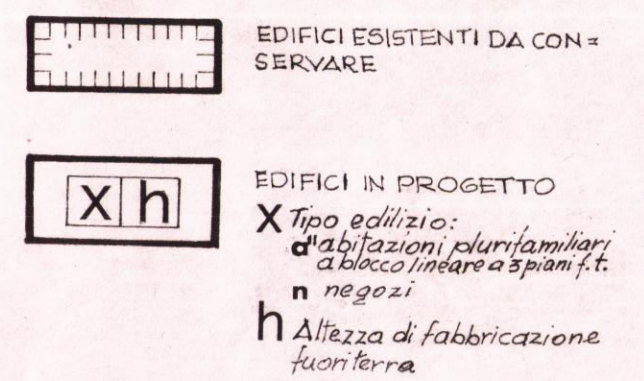

AREE VERDI



LIMITI DI ZONA E DI PROPRIETA'

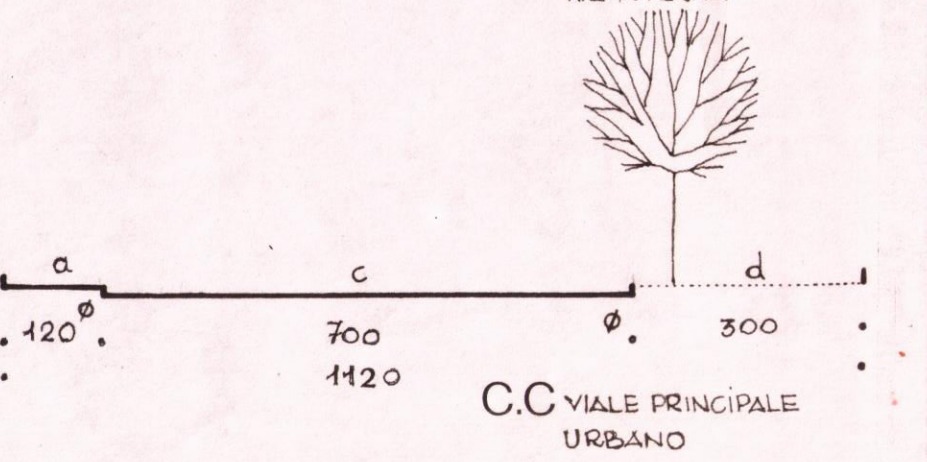
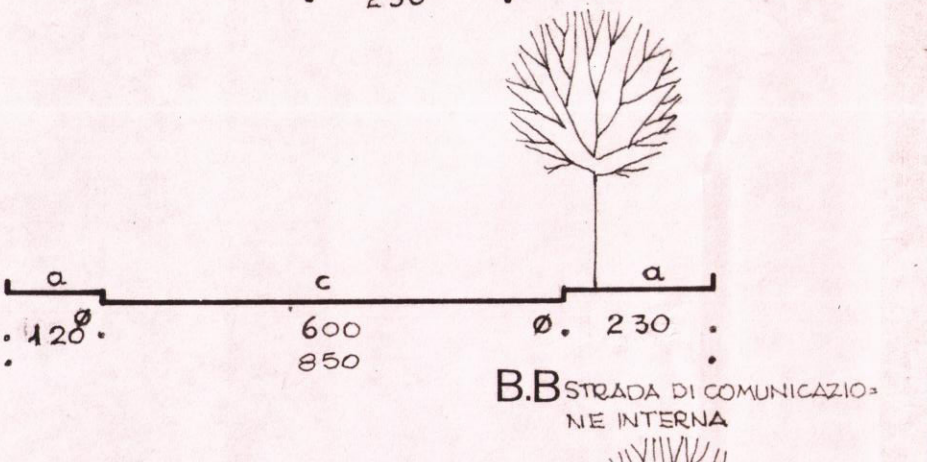
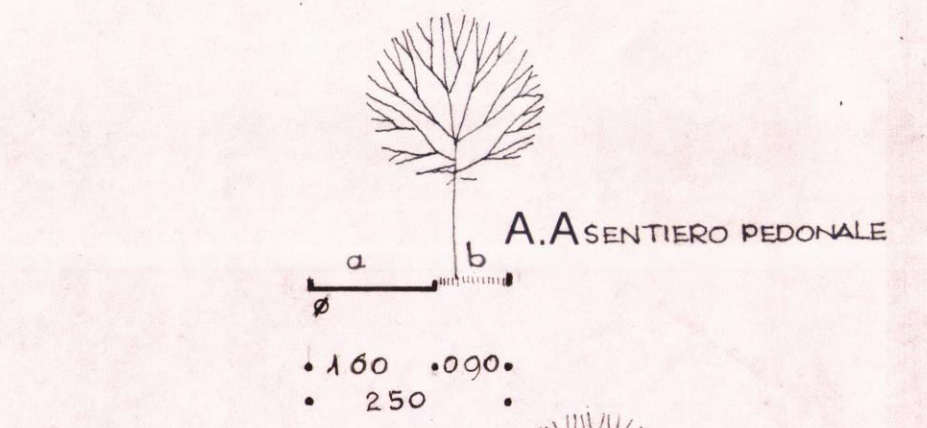
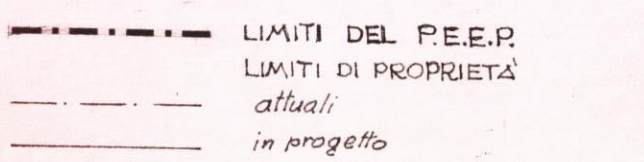

a. lastricato o mattonato
b. manto erboso
c. pietrischetto bitumato
d. ghiaietto
Ø condotti interrati

◀ NORD

