

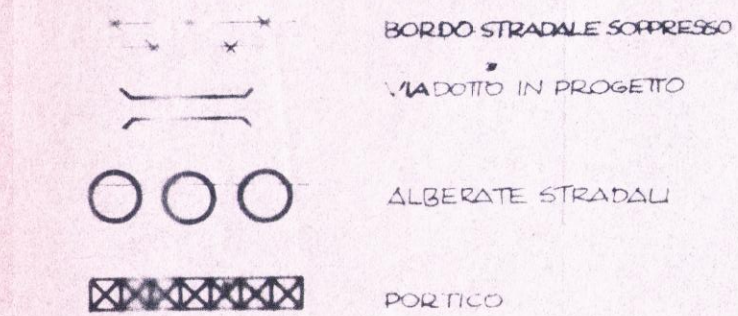

Il Capo Ripartizione

# LEGENDA

## VIE DI COMUNICAZIONE

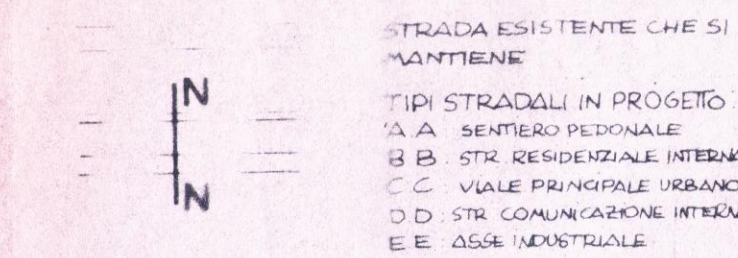

## ZONE RESIDENZIALI

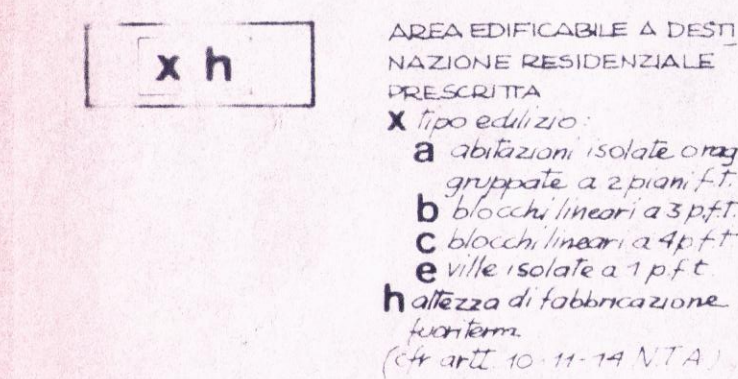
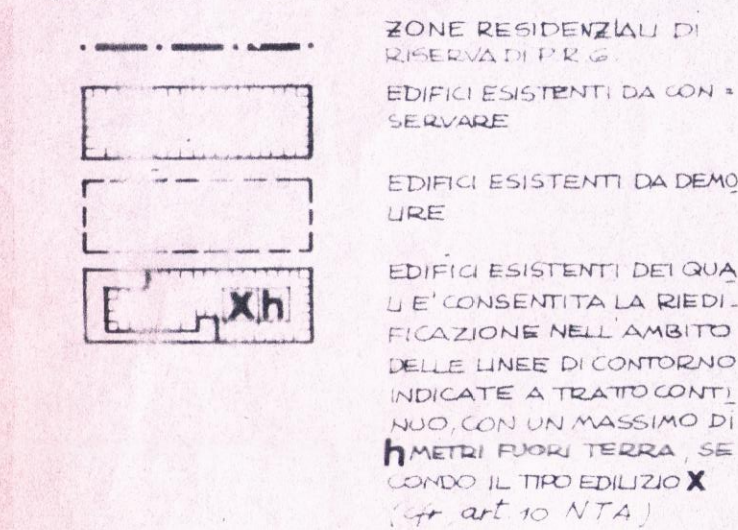

## ZONE INDUSTRIALI

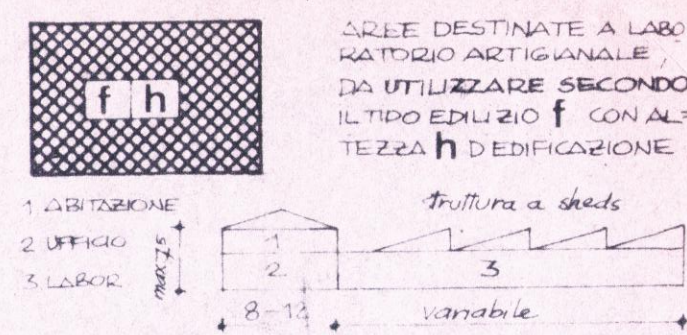
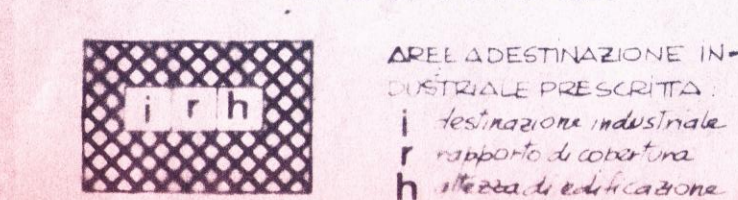

## ATTREZZATURE PUBBLICHE

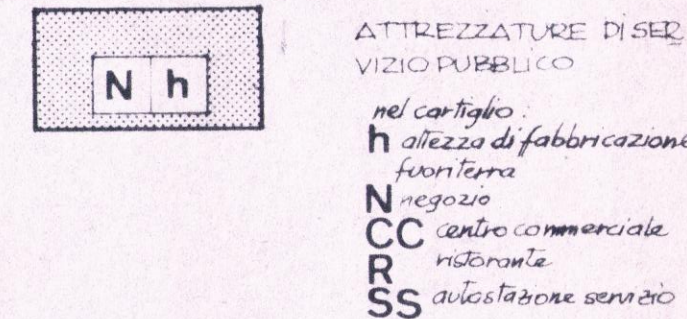

## AREE VERDI



## LIMITI DI ZONA E DI PROPRIETA'

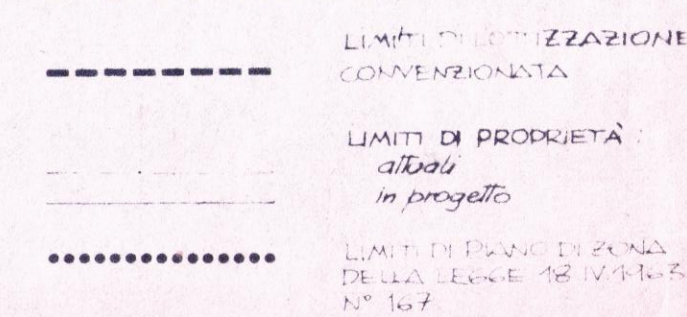

## TIPOLOGIA STRADALE 1:100

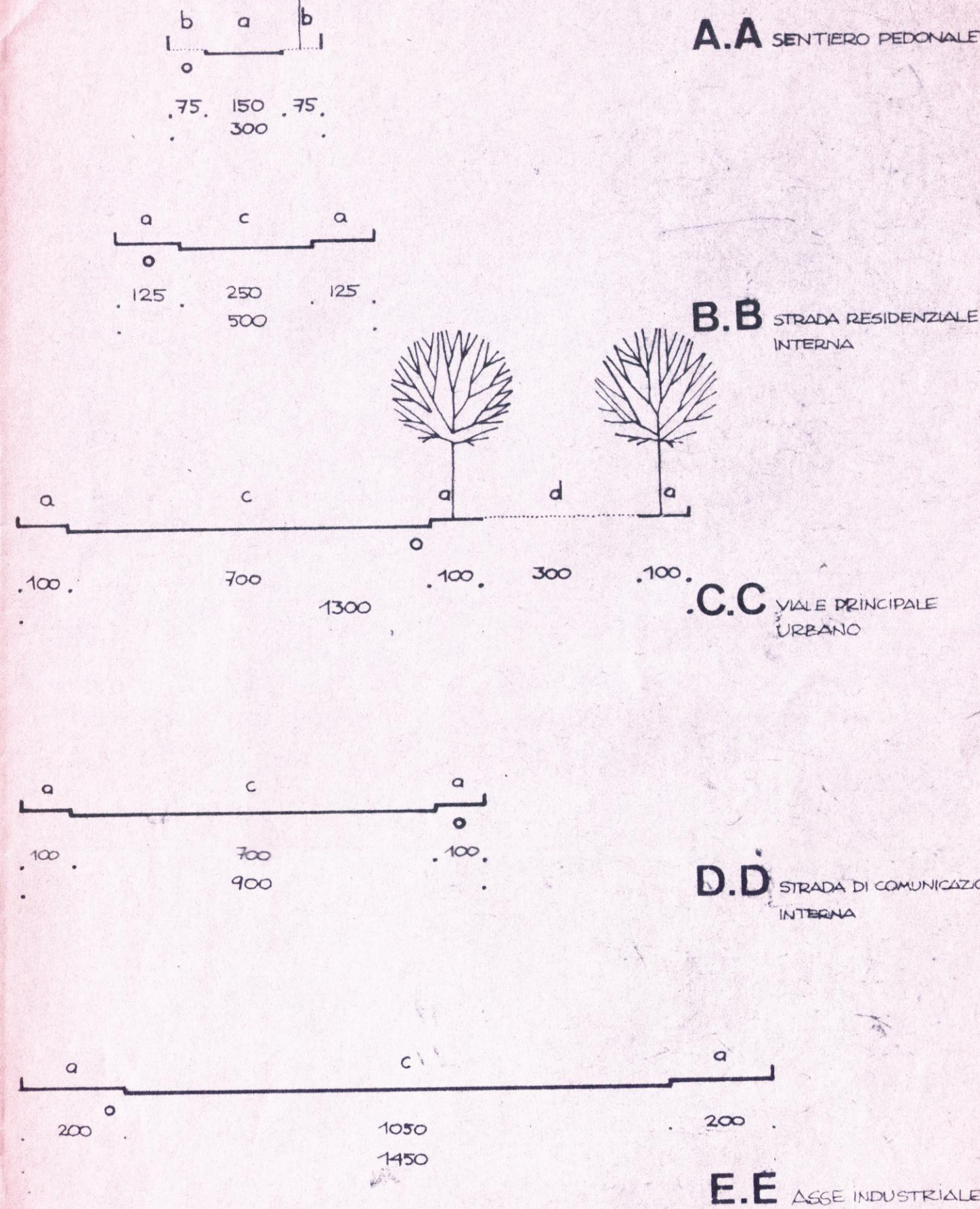

a lastricato o mazzolato  
b marcia erbosa  
c pietrischetto bitumato o ghiaietto  
o condotti interrati

